

FOLSOM STREET

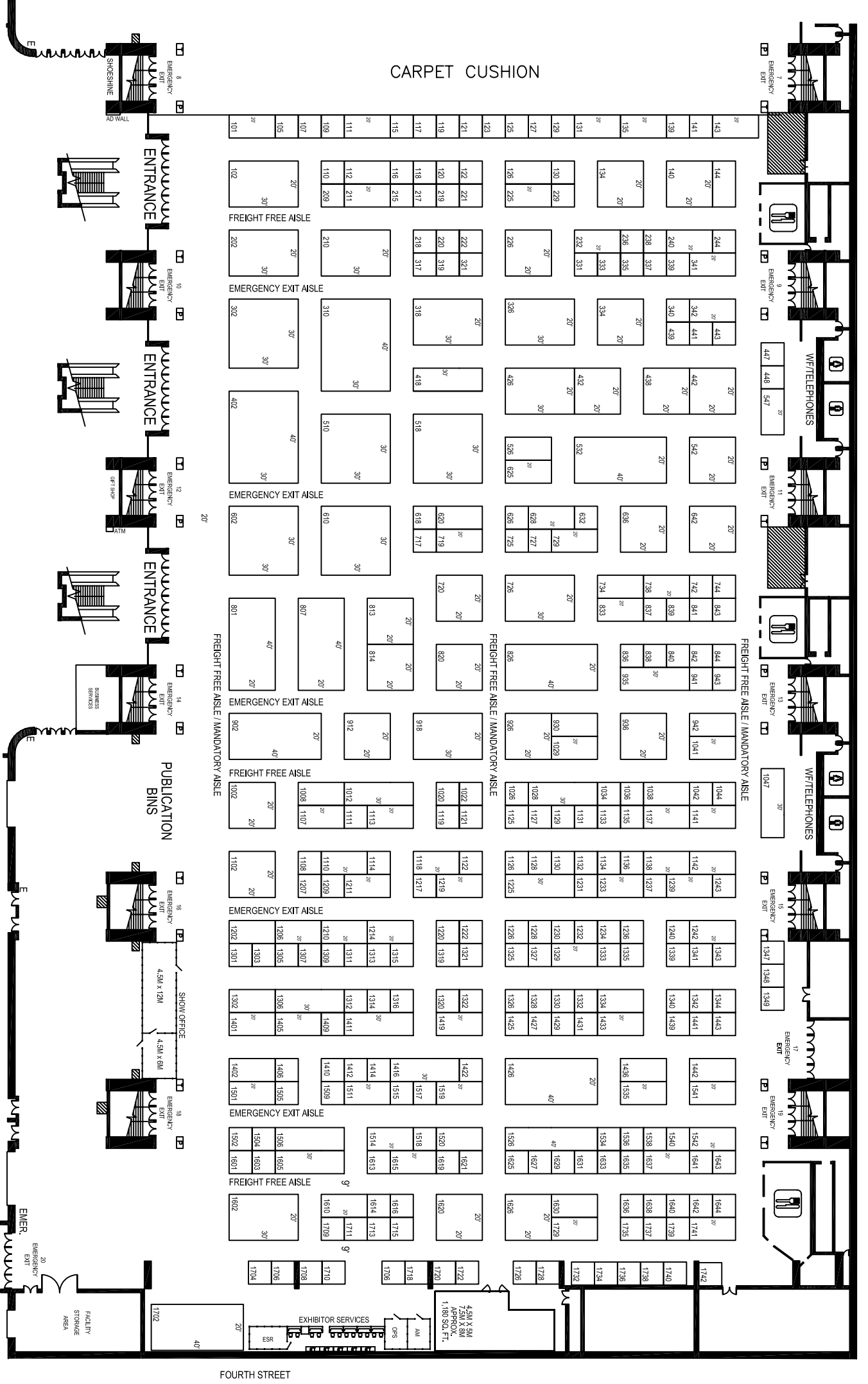

**AUDIO ENGINEERING SOCIETY  
MOSCONE CONVENTION CENTER  
SOUTH EXHIBIT HALLS B & C  
OCTOBER 6 - 8, 2006**

**BOOTH AUDIT**

BOOTH SIZE	SUBTOTAL	SQ. FT.	SUBTOTAL
10'X10'	197	100	19,700
10'X20'	66	200	13,200
10'X30'	11	300	3,300
10'X40'	1	400	400
20'X20'	24	400	9,600
20'X30'	8	600	4,800
20'X40'	7	800	5,400
20'X60'	0	1,200	0
30'X30'	5	900	4,500
30'X40'	2	1,200	2,400
<b>TOTAL:</b>			<b>63,900</b>

☐ DENOTES P.E.R.S. OR TRASH BIN.

MINIMUM AISLE WIDTH: 10'.  
EXCEPTIONS NOTED ON PLAN.

**SOUTH HALLS B & C  
MOSCONE CENTER  
SAN FRANCISCO, CA.**

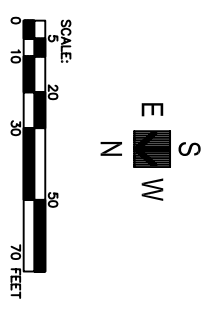

THE JURISDICTIONAL FIRE MARSHAL HAS FINAL APPROVAL OF ALL FLOORPLANS AND OTHER LAYOUTS



3875 BAY CENTER PLACE  
SAN FRANCISCO, CA 94134  
PH: 510-239-3800 FAX: 510-239-6410

COPYRIGHT © BY GES EXPOSITION SERVICES. ALL RIGHTS RESERVED. NO PART OF THIS FLOOR PLAN OR ANY INFORMATION CONTAINED HEREIN IS TO BE REPRODUCED OR TRANSMITTED IN ANY FORM OR BY ANY MEANS, ELECTRONIC, MECHANICAL, PHOTOCOPYING, RECORDING, OR OTHERWISE, WITHOUT THE EXPRESS WRITTEN CONSENT OF GES EXPOSITION SERVICES. THIS PLAN IS CONFIDENTIAL PROPERTY OF GES.

DWG: 06 AES  
DRAWN BY: D.M., B.R.F./M.H.  
AS OF: 9/11/06  
REVISION NUMBER: 12  
A.M.: DEKLAVON